

360 Residential Units
 8,400 Retail/Commercial
 100 Room Extended Stay Residence Inn

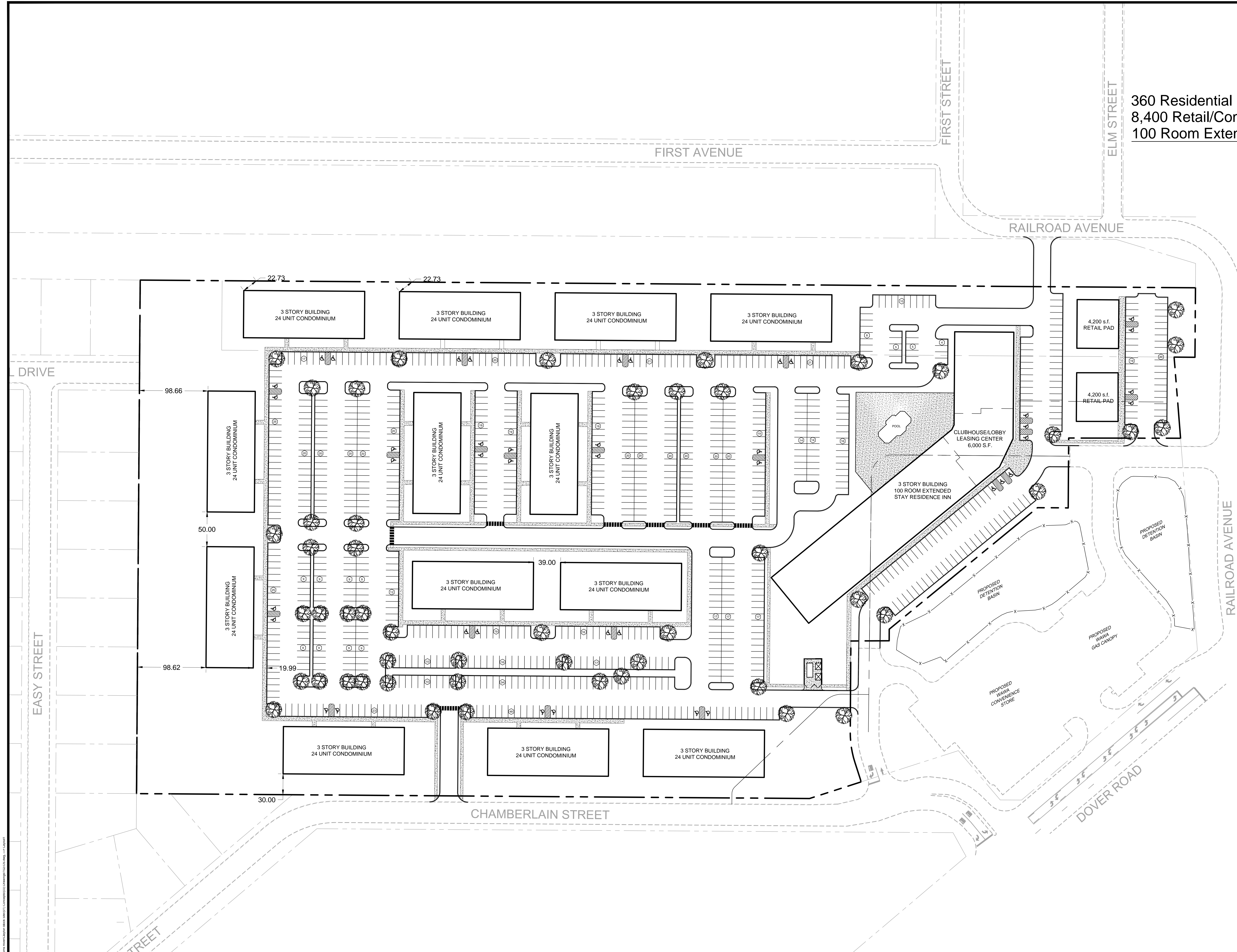

- LEGEND**
- PROPOSED**
- 123 PROP. 1ft CONTOUR LINE
 - 126 PROP. 5ft CONTOUR LINE
 - W PROP. POTABLE WATER LINE
 - SS PROP. SANITARY SEWER LINE
 - G PROP. GAS LINE
 - E PROP. ELECTRIC LINE
 - X-X PROP. FENCE LINE
 - PROP. CURB LINE
 - EXIST. TREE LINE
 - PROP. STORM PIPE
 - PROP. CONCRETE SIDEWALK
 - TC 100.50
GD 100.00 PROP. SPOT ELEVATION
 - PROP. FIRE HYDRANT
 - PROP. SIAMESE CONNECTION
 - PROP. LIGHT POLE
 - PROP. P.I.V.
 - PROP. "B" INLET
 - PROP. UTILITY POLE
 - PROP. MANHOLE
 - PROP. "A" OR "E" INLET
- EXISTING**
- 124 EXIST. 1ft CONTOUR LINE
 - 125 EXIST. 5ft CONTOUR LINE
 - W EXIST. POTABLE WATER LINE
 - SS EXIST. SANITARY SEWER LINE
 - G EXIST. GAS LINE
 - E EXIST. ELECTRIC LINE
 - X-X EXIST. FENCE LINE
 - EXIST. TREE LINE
 - EXIST. CONC. SIDEWALK
 - BOUNDARY LINE
 - PRIMARY BUILDING SETBACK LINE
 - EXIST. CURB LINE
 - EXIST. STORM PIPE
 - TC 100.50
GD 100.00 SPOT ELEVATION
 - EXIST. FIRE HYDRANT
 - SIAMESE CONNECTION
 - EXIST. LIGHT POLE
 - EXIST. "B" INLET
 - EXIST. UTILITY POLE
 - EXIST. MANHOLE
 - EXIST. "A" OR "E" INLET

NO.	REVISIONS	DATE	BY

THIS WORK PREPARED UNDER MY IMMEDIATE SUPERVISION		DATE	BY
BRADFORD J. ALLER		7/24/17	JM
PROFESSIONAL ENGINEER		SCALE	AS SHOWN
N.J.P.E. LIC. NO. GE-43435		PROJECT NO.	101-OS

EP DESIGN SERVICES, LLC
 State of New Jersey Certificate of Authorization #: 24CA28128800
 12100 Sifton Road
 Piscataway, New Jersey 08854
 (732) 965-1900 Fax (732) 965-5588

**PROPOSED OVERALL PLAN
 RESIDENTIAL REDEVELOPMENT**
 FOR
**BLOCK 20 LOTS 11 & 13
 BOROUGH OF SOUTH TOMS RIVER**
 OCEAN COUNTY, NEW JERSEY

THIS DRAWING AND THE INFORMATION ON IT ARE CONFIDENTIAL AND ARE THE PROPERTY OF EP DESIGN SERVICES, LLC. AND MAY NOT BE USED FOR ANY PURPOSE OR PROJECT OTHER THAN THE ONE IDENTIFIED HERE ON WITHOUT WRITTEN CONSENT FROM EP DESIGN SERVICES, LLC.