

BOROUGH OF SOUTH TOMS RIVER OCEAN COUNTY NEW JERSEY

ZONE LEGEND	
R-7	RESIDENTIAL ZONE 7,000 S.F. LOTS
R-10	RESIDENTIAL ZONE 10,000 S.F. LOTS
R-15	RESIDENTIAL ZONE 15,000 S.F. LOTS
B-1	NEIGHBORHOOD BUSINESS/ PROFESSIONAL ZONE
H-D	HIGHWAY DEVELOPMENT ZONE
ML	MUNICIPAL LANDS ZONE
MR	MARINE - RECREATIONAL RESIDENTIAL ZONE
BD	BUSINESS DEVELOPMENT ZONE

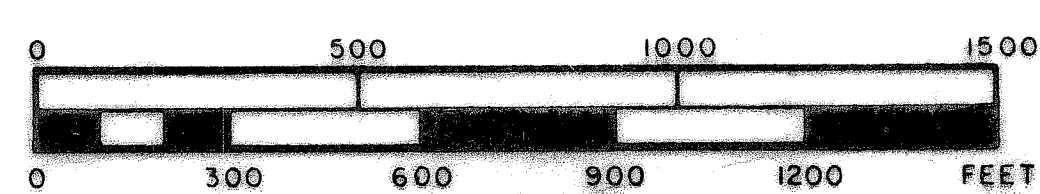
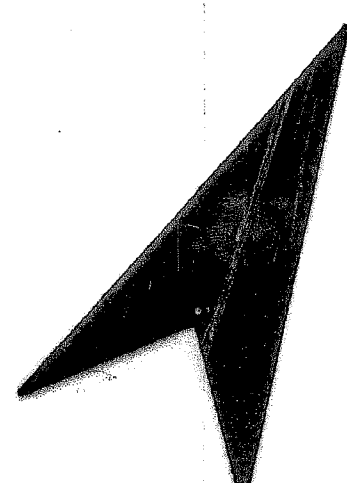
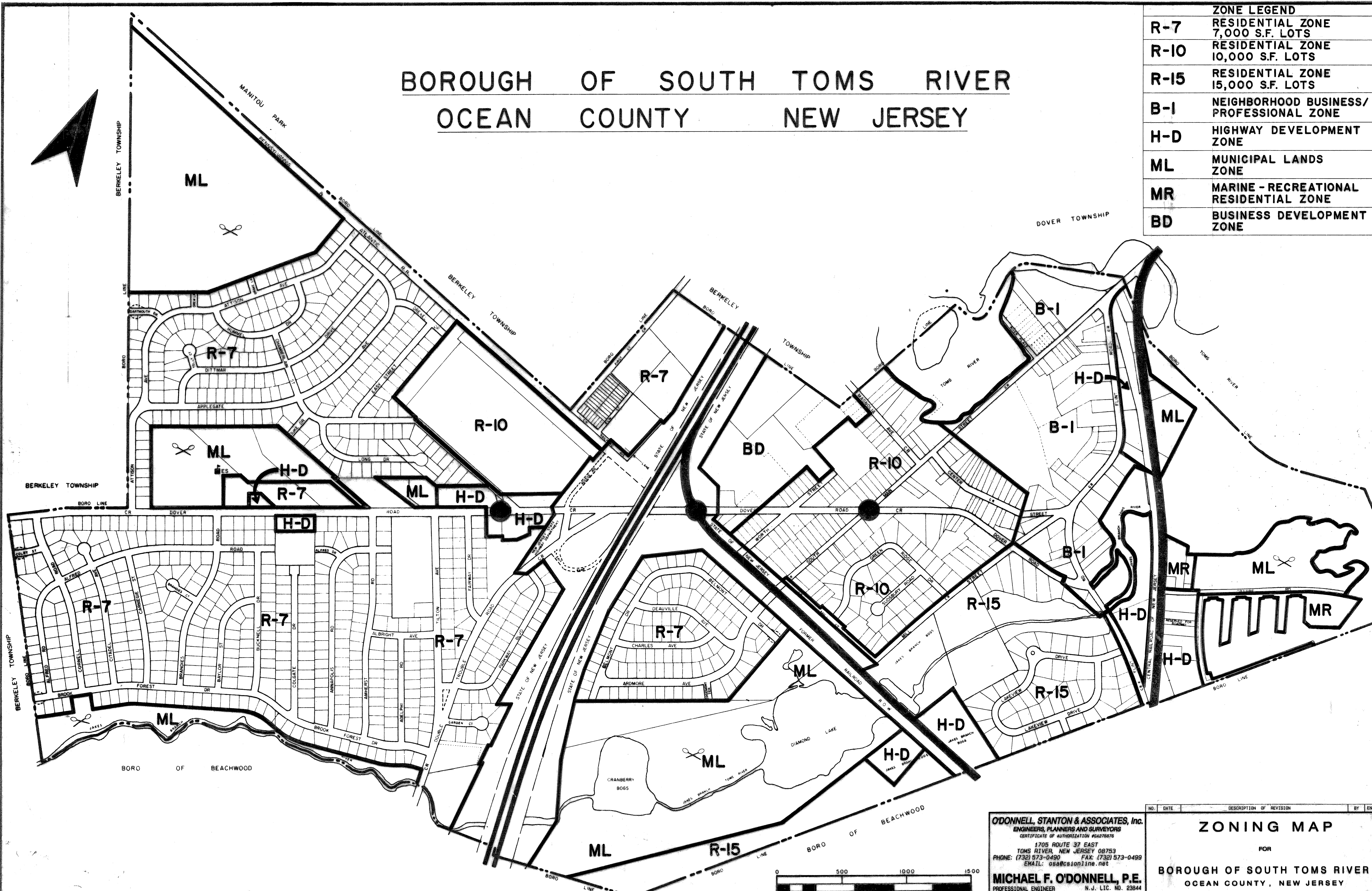

ODONNELL, STANTON & ASSOCIATES, Inc.
ENGINEERS, PLANNERS AND SURVEYORS
CERTIFICATE OF AUTHORIZATION #6A276876
1705 ROUTE 37 EAST
TOMS RIVER, NEW JERSEY 08753
PHONE: (732) 573-0490 FAX: (732) 573-0499
EMAIL: osa@csionline.net

MICHAEL F. O'DONNELL, P.E.
PROFESSIONAL ENGINEER N.J. LIC. NO. 23844

NO.	DATE	DESCRIPTION OF REVISION	BY	ENGR.
ZONING MAP				
FOR				
BOROUGH OF SOUTH TOMS RIVER				
OCEAN COUNTY, NEW JERSEY				
CHECKED BY	CALC. BY	DRAWN BY	SCALE	DATE
CBA	MFO	LLH	1" = 300'	02-18-03
PROJECT NO.	DWG NO.			
91038.00	1			